

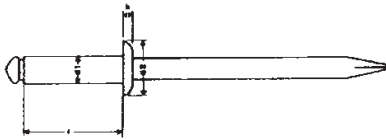

Stainless steel blind rivet with stainless steel shaft



Available material

Material quality : A2 (AISI304)
 : A4 (AISI316)

Available sizes

| Length (l) [mm] | Diameter (d) [mm] | | |
|-----------------|-------------------|-----|-----|
| | 3,2 | 4,0 | 4,8 |
| 4 | | | |
| 6 | x | x | x |
| 8 | x | x | x |
| 10 | x | x | x |
| 12 | x | x | x |
| 14 | x | x | x |
| 16 | | x | x |
| 18 | | x | x |
| 20 | | x | x |
| 25 | | x | |

[‘x’ marks availability]

General rule of thumb for grip range

Maximum grip is length op blind rivet +/- diameter.

Example : blind rivet 3,2 x 10 mm
 : length = 10 mm, diameter = 3,2 mm max grip = 6,8 mm

Minimum grip is maximum grip +/- 2,5 mm.

Applicable standard

EN ISO 15983:2002

IMPORTANT: Insu-W-Rapid BV warrants that each of its products will be manufactured in accordance with the specifications in effect on the date of manufacture.

We make no other warranties and expressly disclaim any warranties of merchantability or fitness for a particular purpose. If a product fails to meet this limited warranty, purchaser’s sole and exclusive remedy is replacement of the product or, at our option, refund of the purchase price. No guarantees for completeness, accuracy or results is expressed nor implied. The suitability of the product to an intended use is the sole responsibility of the user. Since material choice and application method are beyond our control, we accept no liability for direct or consequential damages.